

Installation Instructions

For set # 8.4111

Body Mount Set

1996-1999 Toyota 4Runner



1131 VIA CALLEJON, SAN CLEMENTE, CA 92673

© 2017 Energy Suspension. All rights reserved.
May not be reproduced, in any form, or by any means,
without the written consent of Energy Suspension.

It is recommended that if you are unfamiliar with this type of work that you refer to a qualified service center specializing in this type of work. It is also recommended that if you choose to do this work yourself that a factory service manual be obtained for the proper procedures pertaining to removal, replacement and proper torque specifications for your vehicle. This instruction set is intended as a guideline for the safe installation of Energy Suspension's polyurethane bushings, once you have removed the factory components from your vehicle. Wheel alignment is almost always disturbed when suspension components are removed or replaced. It is recommended that you have the alignment checked on your vehicle at a qualified alignment shop. Energy Suspension recommends that you read over all the installation instructions and check all P/N's and quantities in the parts list before you start. Call customer service at 949-361-3935 if the parts in your kit do not match this parts list. Prior to installation, make sure that your vehicle is in top mechanical condition and that there are no suspension or steering related problems. This part has been designed to work only with a vehicle that is in good state of repair. No matter how carefully we design our parts, this is one area we have no control over and cannot be held responsible.

Parts List for Body mount set: 8.4111

2 - 04P04356 Upper Body Mount POS. 1	10 - 15.03.07.39 Washer, POS. 2,3,4, & 5 Upper & POS. 5 Lower (2.500" x .438" x .120")
2 - 04P04357 Lower Body Mount POS. 1	2 - 15.03.13.39 Washer, lower POS. 1 (1.750" x .438" x .125")
4 - 04P04366 Upper Body Mount POS. 2 & 4	8 - 15.03.59.39 Washer, POS. 1 Upper & POS. 2, 3 & 4 Lower. (2.0" x .406" x .110")
4 - 04P04367 Lower Body Mount POS. 2 & 4	14 - 15.03.69.39 Washer, All POS. Lower & POS. 5 Adapter Plates (.813" x .375" x .100")
2 - 04P04364 Upper Body Mount POS. 3	2 - 15.10.52.39 Sleeve, POS. 1 (.625" x .438" x 2.100")
2 - 04P04365 Lower Body Mount POS. 3	4 - 15P1071139 Sleeve, POS. 2 & 4 (.625" x .406" x 3.080")
2 - 04P04368 Upper Body Mount POS. 5	2 - 15.10.577.39 Sleeve, POS. 5 (.750" x .406" x 2.250")
2 - 04P04369 Lower Body Mount POS. 5	2 - 15P1070939 Sleeve, POS. 3 (.625" x .438" x 3.188")
	2 - 18.08.22.39 Adapter Plates, POS. 5
	1 17P17689 Installation Instructions

Removal:

1. Toyota uses extra long bolts in all positions. For easy removal, wire brush the threads and spray with WD-40. See the "Mount Position Diagram" on page 2 for general location of body mounts.
2. Loosen all body mounting bolts, but only remove one side at a time. Some mounts are accessed from the inside of the cab. The plastic molding will need to be removed and the carpet pulled back to get to the black plastic caps covering the top of the body mount bolts. Remove bolts one side at a time with the bolts on the other side loosened only. (See Fig. 1 thru 4).

Important:

3. Only raise body high enough to remove & replace mounts. Always watch the fan shroud, brake lines, fuel lines, steering coupler and body panels around the bumpers for sufficient clearance when raising the body. When jacking the body use as long as possible 2X4 or 4X4 wood blocks in 2 places for maximum support. Never put jack pad directly on body panels. Be sure to shut all the doors when lifting the body.
4. Install the new upper body mounts and upper washers into positions 1, 2, 3 & 4. For position 5, install the adapter plates with small washers on top of frame perch using the factory bolts. Lower the body until it starts to touch the new washers, open the doors and install the long factory bolts. Lower the body all the way and install the new lower mounts, washers and factory nuts. Keep the nuts only finger tight until both sides are completely installed. Repeat on other side. (See Fig. 5 thru 8 for assembly sequence)

Note: When disassembling, note the quantity and positions of any shims that may have been inserted for body alignment. These shims will have to be reused to ensure proper body alignment.

5. Torque all nuts & bolts to factory specs. Reinstall the black plastic plugs, carpet and plastic panels.

Installation Instructions

For set # 8.4111

Body Mount Set

1996-1999 Toyota 4Runner

ENERGY
SUSPENSION 

1131 VIA CALLEJON, SAN CLEMENTE, CA 92673

© 2017 Energy Suspension. All rights reserved.
May not be reproduced, in any form, or by any means,
without the written consent of Energy Suspension.

Mount Position Diagram

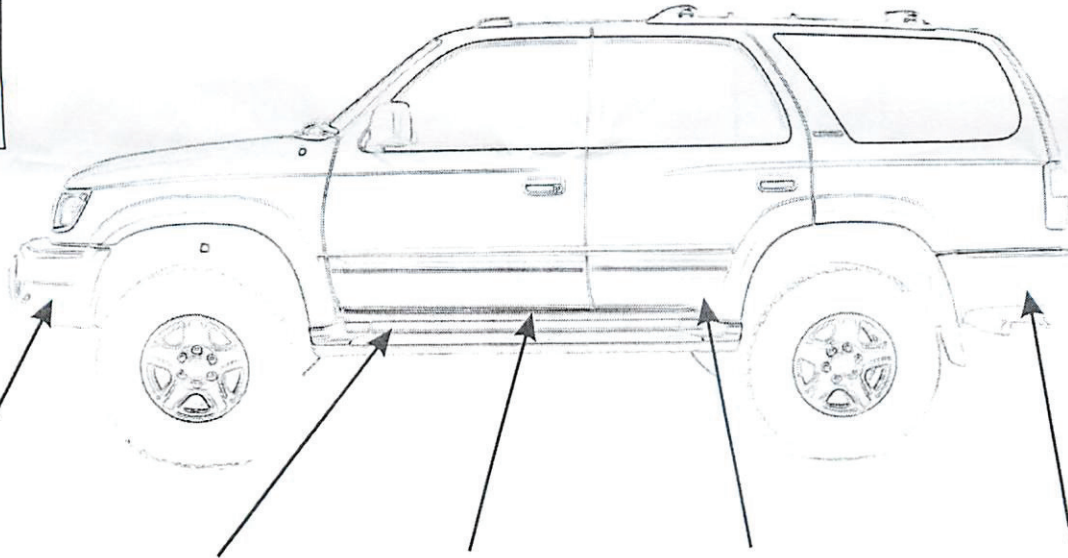

Position 1

Position 2

Position 3

Position 4

Position 5

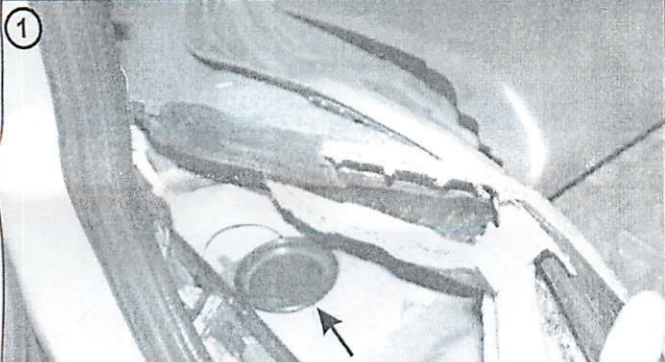
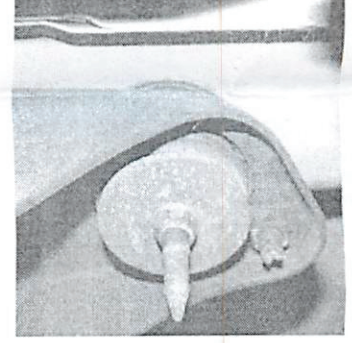
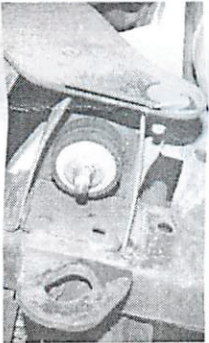

①
Position 2 bolt is located near front kick panel.
Remove the plastic door trim and kick panel, pull up
carpet and remove the black round plug.



②
Position 3 bolt is located near the B pillar. Remove the
plastic trim around the B pillar, pull up carpet and
remove the black round plug.

Installation Instructions

For set # 8.4111

Body Mount Set

1996-1999 Toyota 4Runner



1131 VIA CALLEJON, SAN CLEMENTE, CA 92673

© 2017 Energy Suspension. All rights reserved.
 May not be reproduced, in any form, or by any means,
 without the written consent of Energy Suspension.

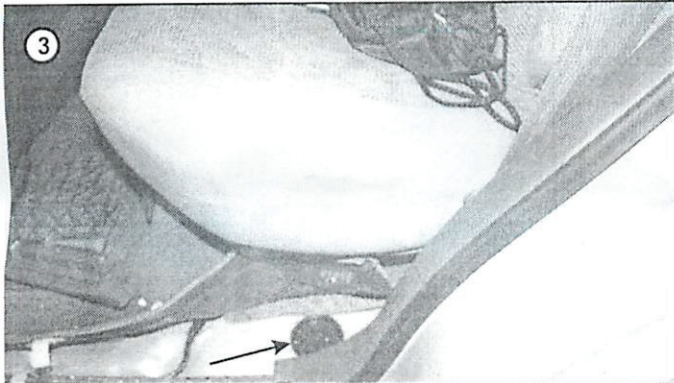

Position 4 bolt is located below the rear seat. Remove the plastic trim and panels, pull up carpet and remove the black round plug.

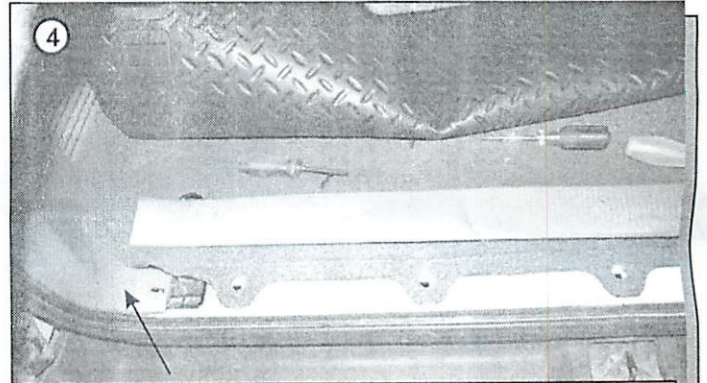

Position 5 bolt is located at very rear. Remove the plastic trim and rear panels, pull up carpet and remove the black square plug.

⑤ POSITION 1



⑥ POSITION 2 & 4

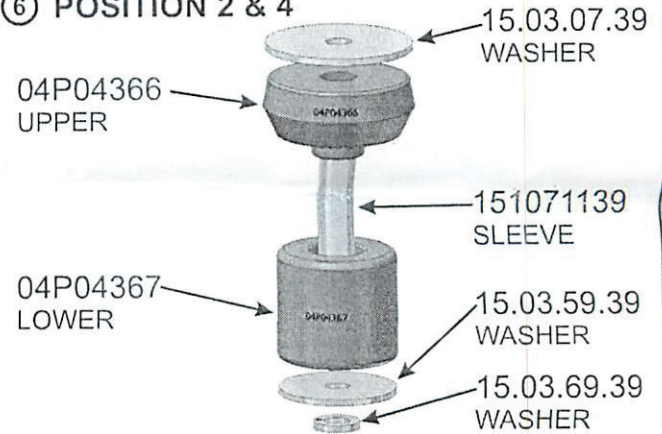

⑦ POSITION 3



⑧ POSITION 5

