

# Installation Instructions

## Set #16-3106 & 16-3110



1131 VIA CALLEJON, SAN CLEMENTE, CA 92673

1. Properly support the vehicle on the frame.
2. Unbolt the upper control arm and pivot bushing assembly from the vehicle. Unbolt the upper control arm from the pivot bushing assembly (Note the position of the pivot assembly as you must reassemble them the same way.).
3. Remove the rubber bushing and shells from the pivot bushing assembly. A hydraulic press will be needed. Clean the pivot bushing assembly and lubricate the inside of the barrel. Grease all sides of the bushing that contact metal. Press in the Energy Suspension bushing from each side. Grease and install the sleeve. See diagram.
4. Reassemble and reinstall the upper control arm assembly onto the vehicle.
5. Remove the lower control arm.
6. Press out the inner control arm bushing including it's shell from the control arm.
7. Grease the I.D. of the lower control arm (where the shell was). Grease the Energy Suspension bushing. Grease all sides of the bushing that contact metal.
8. Install the bushings. There are three bushing for this location. Two will be the same and one is different. Install the bushing with the flange first then install the bushing without the flange next. Install the remaining part. Grease the sleeve and install the sleeve.
9. Reassemble the control arm onto the vehicle. Tighten all fasteners to factory specs.
10. Perform a complete wheel alignment after completion of work.

### Upper Control Arm

Supplied Sleeve  
15.10.244.39  
.750"O.D. X .406" I.D. X 1.577"

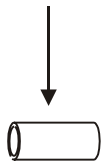

2280

Factory Upper Control Arm Pivot Bracket

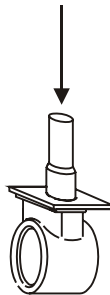

2280

Factory Upper Control Arm Pivot Bracket

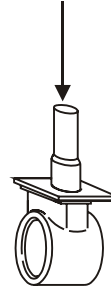

2280

Supplied Sleeve  
15.10.244.39  
.750"O.D. X .406" I.D. X 1.577"

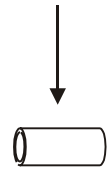

2280

Set#	Bushing "A"	Supplied Sleeve
16-3106	2294	15.10.224.39 (.750"O.D. X .480" I.D. X 2.225")
16-3110	2306	15.10.302.39 (.750"O.D. X .480" I.D. X 2.040")

**It is recommended that a factory service manual be purchased prior to performing any work on your car or truck.**

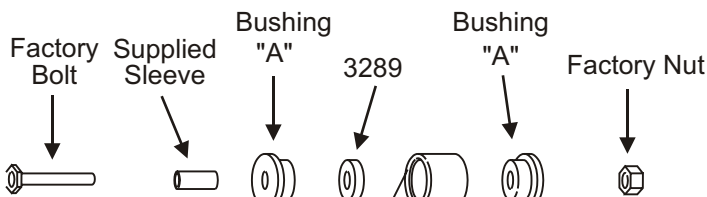

**DO NOT REMOVE THIS BUSHING!**  
This bushing is supplied in set # 16-8106

Factory Lower Control Arm

Lower Control Arm

### Other Energy Suspension Sets Available for this vehicle:

16-8106	Front shock bushing set
16-7103	Front strut bushing set
16-13102	Balljoint boot set
9-13103	Tie-rod boots

17152

7/25/96 KN  
Updated 14/FEB/02 BRH

© 2002 Energy Suspension. All rights reserved.  
May not be reproduced, in any form, or by any means, without the written consent of Energy Suspension.