

# **JEEP CJ**

## **BODY MOUNT BUSHING KIT**

### **INSTALLATION INSTRUCTIONS**

**1976-79** **KIT # 19005**

#### **⚠ WARNING**

Before installing this kit, read and understand all procedures, warnings, cautions, and notes in this instruction sheet. Also, read the appropriate sections of the factory service manual and the vehicle owner's manual before installing this body bushing kit.

#### **⚠ WARNING**

Proper installation of this kit requires knowledge of the factory recommended procedures for removal and installation of original equipment components. Performance Automotive Group recommends that the factory shop manual and any special tools needed to service the vehicle be on hand during installation. Installation of this kit without proper knowledge of the factory recommended procedures may affect the performance of these components and the safety of the vehicle. Performance Automotive Group strongly recommends that a certified mechanic familiar with the installation of offroad products install this kit.

#### **⚠ WARNING**

This kit should only be installed on a vehicle that is in good mechanical condition. Before installation, thoroughly check for corrosion or deformation of the sheet metal around the body mounts. If the vehicle is suspected to have been in a collision or abused, DO NOT install the kit. The components in this kit do not eliminate weaknesses that may exist in the original equipment components.

#### **⚠ WARNING**

Accidental deployment of an airbag in the Supplemental Restraint System (SRS) can result in serious personal injury or death. During kit installation, to prevent the airbag from being accidentally deployed, ground yourself and the vehicle. DO NOT use power tools when working near airbag sensors and wiring. DO NOT allow anyone near the airbags. If desired, deactivate the SRS according to the manufacturer's procedure, then reactivate it after installation is complete.

#### **⚠ WARNING**

Always wear eye protection when operating power tools.

#### **⚠ WARNING**

Performance Automotive Group recommends applying the kit Loctite® to the threads of all nuts and bolts involved in this procedure unless specified otherwise.

# Before Starting Installation

## ⚠ NOTE

Kit parts are prefaced by the word **kit** and appear in **bold print**.

1. Carefully read all warnings and instructions completely before beginning.
2. Verify all parts have been received in this kit by checking the parts list at the end of this document.
3. **Only install this kit on the vehicle for which it is specified.** If anytime during the installation you encounter something different from what is outlined in the instructions, call technical support at (928) 636-7080.
4. Park the vehicle on a clean, dry, flat, level surface and block the tires so the vehicle cannot roll in either direction.

## Prepare to Install Kit

1. Battery Cables.
  - a. Disconnect both battery cables. Disconnect negative cable first, then positive cable.

## Install Kit

### ⚠ WARNING

Although the factory body mount bushings will not be reinstalled, the factory *hardware* (washers, sleeves, shims, etc.) **MUST** be reinstalled along with the kit **bushings**. Failure to reinstall the factory hardware could cause the mounts to fail, possibly resulting in damage to the vehicle or serious personal injury.

### ⚠ WARNING

To prevent serious personal injury while lifting the body, ensure the lifting device is secure. Use extreme caution. Keep hands out from between the body and frame.

### ⚠ CAUTION

To prevent damage to the vehicle while lifting the body, lift it no further than is necessary to replace the bushings. Frequently check to ensure the fan is not contacting the fan shroud and any hoses, wires, and brake lines are not stressed or kinked

1. Loosen, DO NOT remove, bolt at positions 2 through 6 on driver side.
2. Remove bolt from position 1 and from positions 2 through 6 on passenger side. Clean bolt threads.

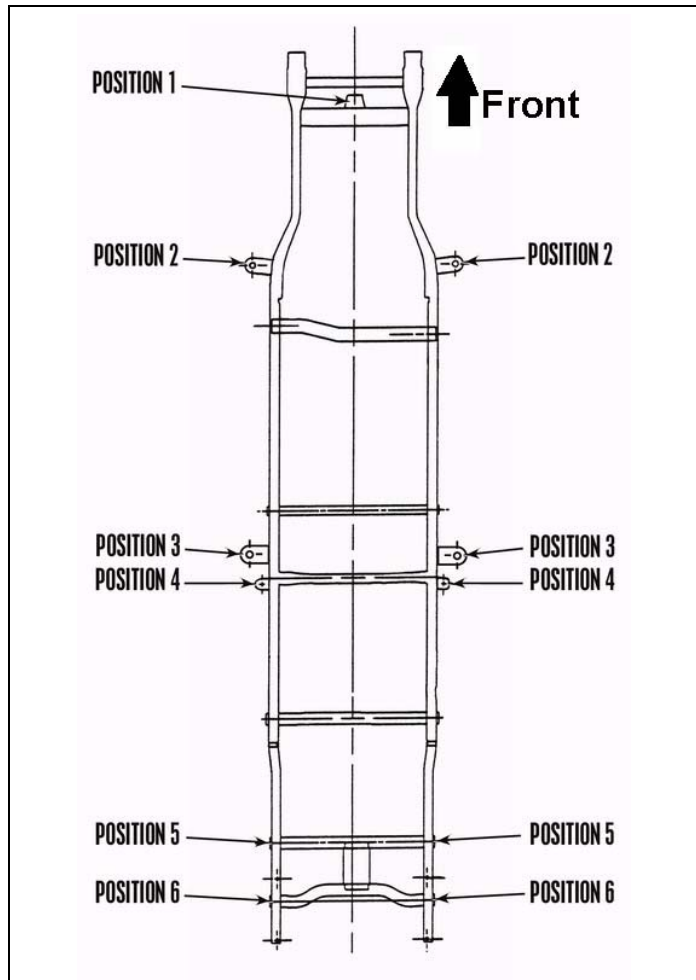

3. Using a hydraulic jack and a wooden block, slowly lift passenger side of body just high enough to allow removal of bushings.
4. Remove bushing and washer/sleeve from positions 2 through 6 on passenger side.
5. Set kit **bushing** (upper) and washer/sleeve on frame at positions 2 through 6 on passenger side.

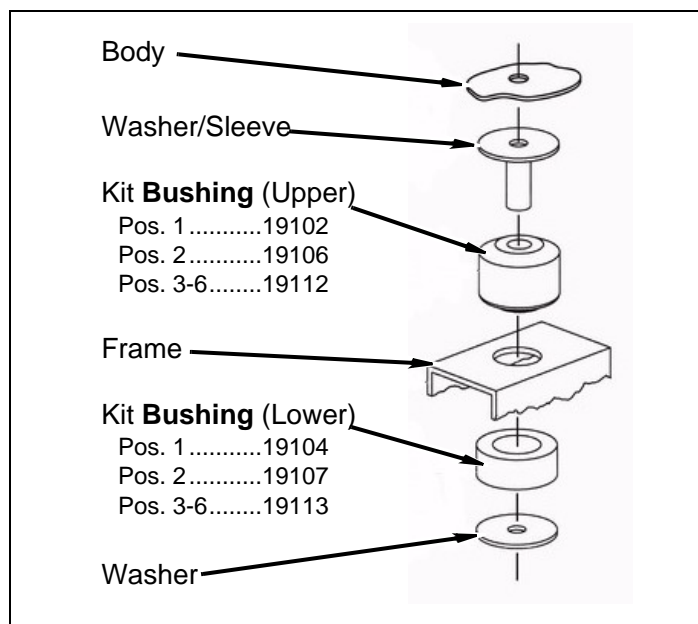

6. Lower the body onto the mounts.
7. Install kit **bushing** (lower), washer, and bolt at positions 2 through 6 on passenger side. **DO NOT** tighten.
8. Repeat previous steps on driver side, being sure to also replace bushings at position 1.
9. Remove each bolt one at a time, apply Loctite® to threads, install bolt, and tighten to manufacturer's specification.

## After Completing Installation

1. Battery Cables.
  - a. Connect both battery cables. Connect positive cable first, then negative cable.

## 2. Miscellaneous

- a. Check all fasteners for proper torque. Check to ensure there is adequate clearance between all fixed and moving parts including exhaust components, brake lines, fuel lines, fuel tank, floor board, and wiring harnesses.

### ⚠ WARNING

All warranty information, instruction sheets, and other documents regarding the installation of this product must be retained by the vehicle owner. Information contained in the instructions and on the warranty card will be required for any warranty claims. The vehicle owner needs to understand the modifications made to the vehicle and how they affect handling and performance. Failure to provide the customer with this information can result in damage to the vehicle or serious personal injury.

### ⚠ CAUTION

Retorque all fasteners after 500 miles and after off road use. All body lift components should be visually inspected and fasteners retorqued during routine vehicle servicing.

Rev. 2, Copyright 01/05 Performance Automotive Group

## Kit Parts List

Qty.	Description
1	<b>Bushing</b> , 19102 (Pos. 1, upper)
1	<b>Bushing</b> , 19104 (Pos. 1, lower)
2	<b>Bushing</b> , 19106 (Pos. 2, upper)
2	<b>Bushing</b> , 19107 (Pos. 2, lower)
8	<b>Bushing</b> , 19112 (Pos. 3-6, upper)
8	<b>Bushing</b> , 19113 (Pos. 3-6, lower)
1	<b>Loctite</b> , 6ml tube