

Installation Guide

Rear Upper Control Arm Rear Bush

Z5107

Suits: Chevrolet Camaro 10/on

(Always refer to the current catalogue for complete application listings)

N.B: This installation guide should be used in conjunction with the workshop manual.
All fastener torque settings should be adhered to.
It is recommended that a wheel alignment is carried out after fitment.

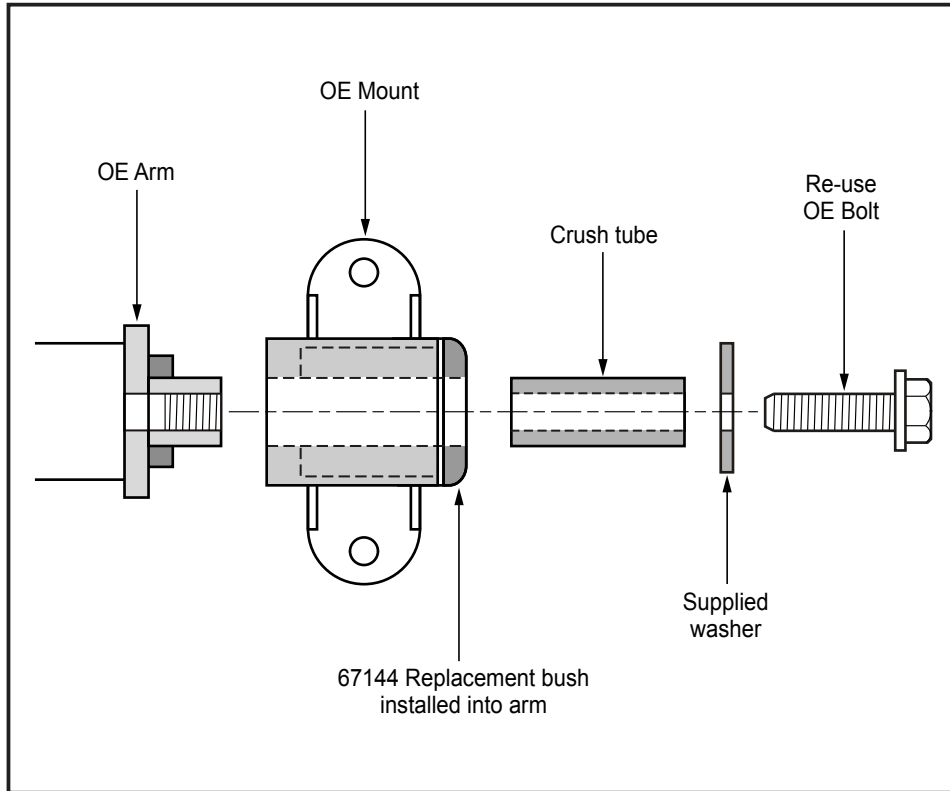

N.B: It is recommended that a licenced workshop or trades person carry out the above procedure and that workshop manual and relevant safety procedures are followed in addition to the above.

Installation Guide

Rear Upper Control Arm Rear Bush

Z5107

Suits: Chevrolet Camaro 10/on

(Always refer to the current catalogue for complete application listings)

N.B: This installation guide should be used in conjunction with the workshop manual.
All fastener torque settings should be adhered to.
It is recommended that a wheel alignment is carried out after fitment.

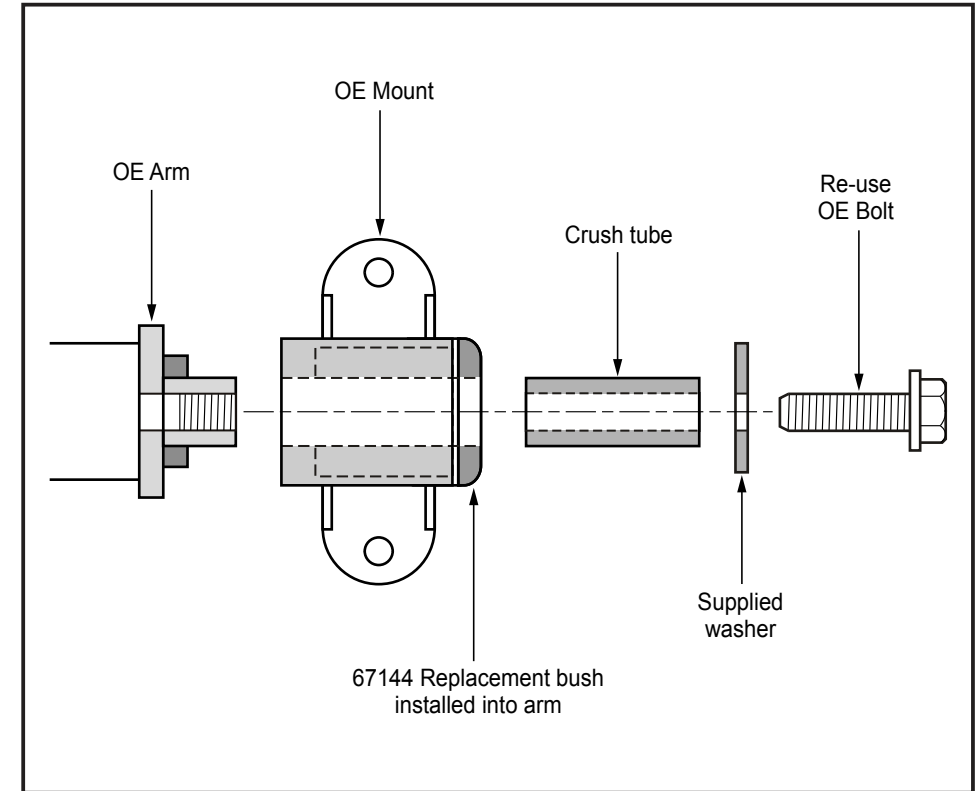

N.B: It is recommended that a licenced workshop or trades person carry out the above procedure and that workshop manual and relevant safety procedures are followed in addition to the above.