

Installation Guide Lower Control Arm Rear Bush

Z 5147

Suits: Ford Focus

(Always refer to the current catalogue for complete application listings)

N.B: This installation guide should be used in conjunction with the workshop manual.

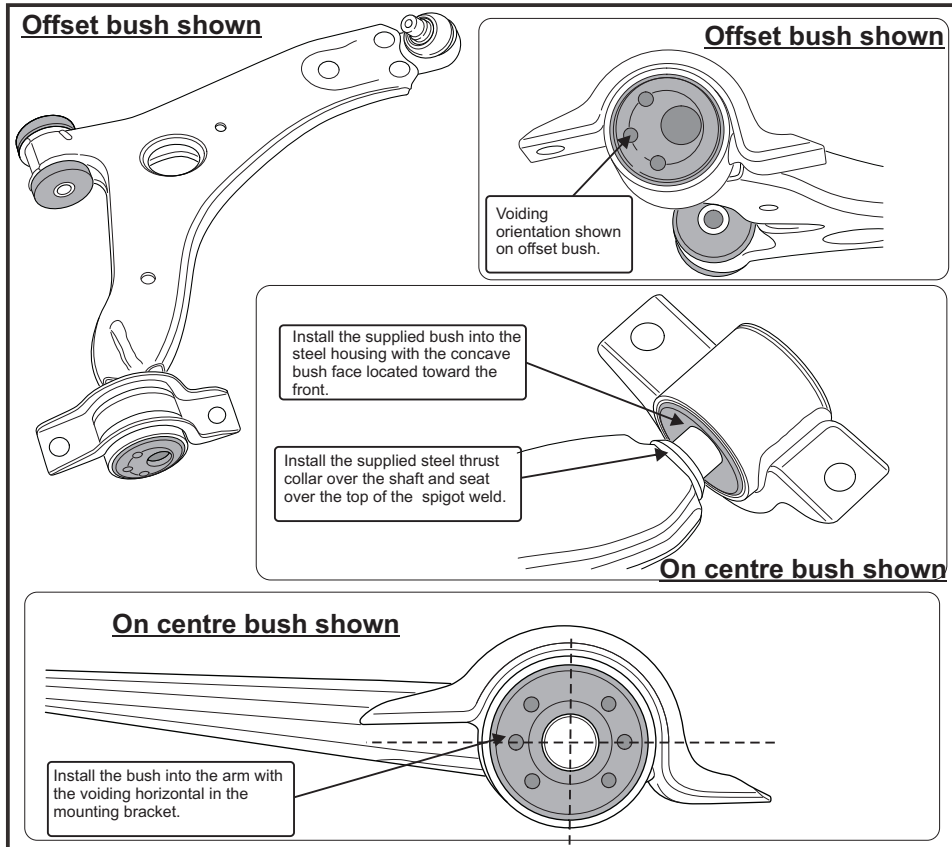

- Please ensure control arm spigot is smooth and free from burrs.
- Install the steel shelled bush into the housing ensuring the steel shell is pressed flush into the housing.

N.B: It is recommended that a licenced workshop or trades person carry out the above procedure and that workshop manual and relevant safety procedures are followed in addition to the above.

Installation Guide Lower Control Arm Rear Bush

Z 5147

Suits: Ford Focus

(Always refer to the current catalogue for complete application listings)

N.B: This installation guide should be used in conjunction with the workshop manual.

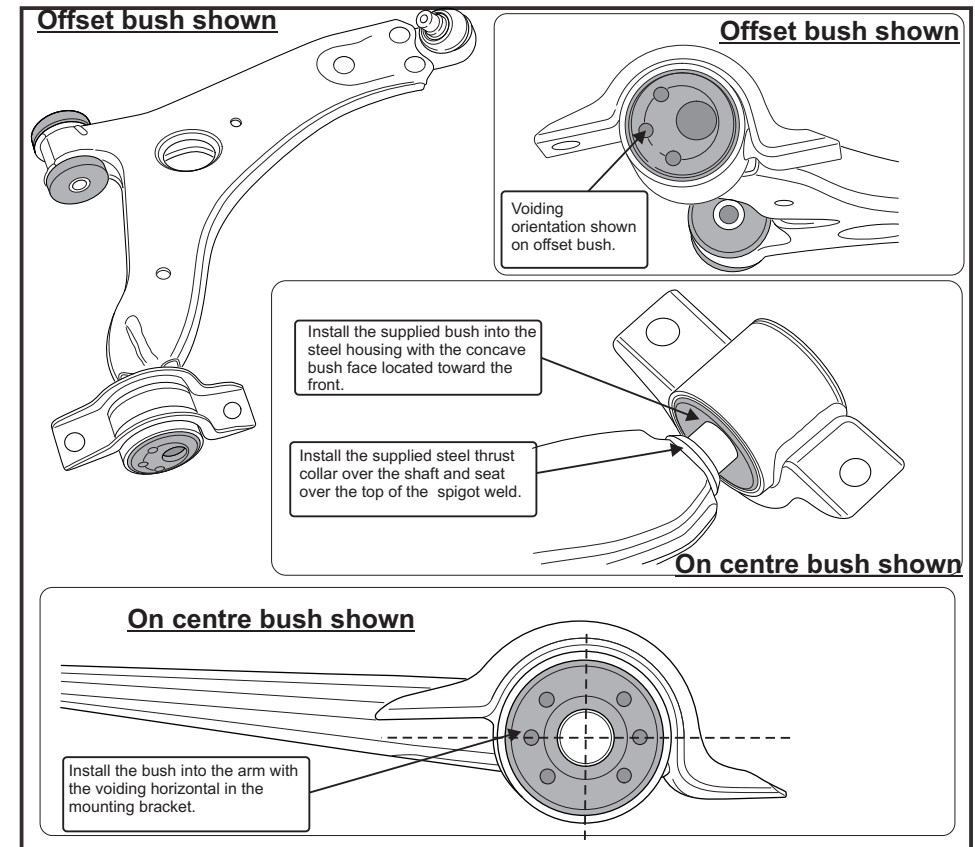

- Please ensure control arm spigot is smooth and free from burrs.
- Install the steel shelled bush into the housing ensuring the steel shell is pressed flush into the housing.

N.B: It is recommended that a licenced workshop or trades person carry out the above procedure and that workshop manual and relevant safety procedures are followed in addition to the above.